

Estrattori universali a due zampe
in cromo vanadio, zincati, vite brunita
2 jaws standard pullers

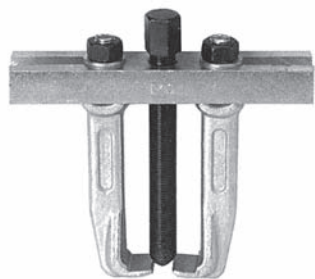

Cod.	Aper. mm	Prof. mm		
AT1010	60	75	1	350
AT1011	80	75	1	600
AT1012	120	100	1	1200
AT1013	140	100	1	1400
AT1014	200	140	1	2700
AT1015	250	250	1	9000
AT1016	300	250	1	12500

Zampe di ricambio per cod. AT1010 ÷ AT1016
in cromo vanadio, zincate
Normal spare jaws for standard pullers



Cod.	Per codice		
AT1017	AT1010	1	70
AT1018	AT1011	1	150
AT1019	AT1012-AT1013	1	200
AT1020	AT1014	1	300
AT1021	AT1015	1	1200
AT1022	AT1016	1	1500

Estrattori universali a tre zampe
in cromo vanadio, zincati, vite brunita
3 jaws standard pullers

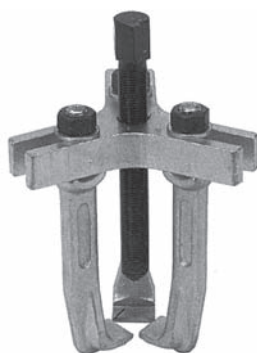

Cod.	Aper. mm	Prof. mm		
AT1023	90	75	1	850
AT1024	120	100	1	1550
AT1025	180	140	1	3900
AT1026	250	250	1	12000
AT1027	300	250	1	13000

Zampe di ricambio per cod. AT1023 ÷ AT1027
in cromo vanadio, zincate
Normal spare jaws for standard pullers



Cod.	Per codice		
AT1028	AT1023	1	100
AT1029	AT1024	1	210
AT1030	AT1025	1	450
AT1031	AT1026	1	1400
AT1032	AT1027	1	1500

Estrattori universali a due zampe
in cromo vanadio, zincati, vite brunita
2 jaws standard pullers for internal and external



Cod.	Aper. mm	Prof. mm		
2600/1	60	75	1	350
2600/2	80	75	1	600
2600/3	100	75	1	650
2600/4	120	100	1	1200
2600/5	140	100	1	1250
2600/6	160	100	1	1500
2600/7	180	140	1	2600
2600/8	200	140	1	2700

Estrattori universali a tre zampe
in cromo vanadio, zincati, vite brunita
3 jaws standard pullers



Cod.	Aper. mm	Prof. mm		
2800/1	90	75	1	850
2800/2	120	100	1	1550
2800/3	160	100	1	2000
2800/4	180	140	1	3900
2800/5	250	250	1	12000

Estrattori universali a due zampe scorrevoli

in cromo vanadio, zincati, vite brunita
2 jaws pullers for internal and external



Cod.	Aper. mm	Prof. mm		
2700/1	60	70	1	270
2700/2	80	100	1	800
2700/3	120	100	1	900
2700/4	160	150	1	2800
2700/5	200	150	1	3000
2700/6	250	200	1	6600

Estrattori autoserranti a due zampe

in cromo vanadio, zincati, vite brunita
 adatto per diverse operazioni in autoriparazione.
2 jaws self-tightening puller suitable for different operations of self repairs



Cod.	Aper. mm	Prof. mm		
AT4000	100	85	1	400
AT4001	140	120	1	900

Estrattori autoserranti a due zampe sottili

in cromo vanadio, zincati, vite brunita
2 jaws self locking pullers for exteriors and interiors with thin jaws



Cod.	Aper. mm	Prof. mm		
AT4010	55	40	1	150
AT4011	65	65	1	150
AT4012	80	80	1	300
AT4013	120	120	1	750
AT4014	160	160	1	1800
AT4015	225	200	1	3750
AT4016	300	300	1	8300
AT4017	425	425	1	10000

Estrattori autoserranti a tre zampe sottili

utilizzo in spazi ristretti
 in cromo vanadio, zincati, vite brunita
3 jaws self locking pullers for exteriors and interiors with thin jaws to be used in narrow spaces



Cod.	Aper. mm	Prof. mm		
AT4020	55	40	1	240
AT4021	65	65	1	240
AT4022	80	80	1	450
AT4023	120	120	1	1050
AT4024	160	160	1	2500
AT4025	225	200	1	5200
AT4026	300	300	1	10000
AT4027	425	425	1	12400

Estrattori autoserranti reversibili a due zampe

in cromo vanadio, zincati, vite brunita
3 jaws self locking pullers for exteriors and interiors with a different shape of the jaws, it permits to operate in difficult situations



Cod.	Aper. mm	Prof. mm		
AT4030	150	80	1	800
AT4031	200	130	1	1900

Estrattori autoserranti reversibili a tre zampe

in cromo vanadio, zincati, vite brunita
3 jaws self locking pullers for exteriors and interiors with different shape of the jaws, it permits to operate in difficult situations



Cod.	Aper. mm	Prof. mm		
AT4040	150	80	1	1050
AT4041	200	130	1	2700

Estrattori autoserranti regolabili a due zampe

in cromo vanadio, zincati, vite brunita

2 jaws self locking pullers for exteriors and interiors jaws for strong stresses



Cod.	Aper. mm	Prof. mm		
AT4050	100	100	1	350
AT4051	150	150	1	900
AT4052	220	220	1	2100
AT4053	300	270	1	4500
AT4054	350	400	1	5200

Estrattori autoserranti regolabili a tre zampe

in cromo vanadio, zincati, vite brunita

3 jaws self locking pullers for exteriors and interiors jaws for strong stresses



Cod.	Aper. mm	Prof. mm		
AT4060	100	100	1	450
AT4061	150	150	1	1100
AT4062	220	220	1	3000
AT4063	300	270	1	6000
AT4064	350	400	1	7100

Estrattori universali a due zampe scorrevoli

in cromo vanadio, zincati, vite brunita

2 jaws pullers for exteriors and interiors sliding jaws along the transom. Clamping by the jaw bolts



Cod.	Aper. mm	Prof. mm		
AT4070	80	98	1	1000
AT4071	130	98	1	1150
AT4072	160	150	1	3100
AT4073	200	150	1	3500
AT4074	250	200	1	6600
AT4075	350	200	1	7500
AT4076	520	200	1	13700

Zampe di ricambio per cod. AT4070-AT4076

in cromo vanadio, zincate

Spare jaws for code AT4070-AT4076



Cod.	Per cod.	Prof. mm		
AT4080	AT4070-AT4071	98	1	250
AT4081	AT4072-AT4073	150	1	650
AT4082	AT4074-AT4076	200	1	1600

Zampe prolungate di ricambio per cod. AT4070-AT4076

in cromo vanadio, zincate

Spare jaws for code AT4070-4076



Cod.	Per cod.	Prof. mm		
AT4083	AT4070-AT4071	200	1	500
AT4084	AT4072-AT4073	300	1	1100
AT4085	AT4074-AT4076	300	1	2200
AT4086	AT4074-AT4076	400	1	2680
AT4087	AT4074-AT4076	500	1	3200

Assortimento estrattori universali a due e tre zampe

in Cromo vanadio, cromati, vite brunita

Universal puller set



Cod.	Pz./Pcs.		
AT1037	12	1	7700

Composizione:

	Aper. mm.	Pz.
Traversa per due zampe	140	1
Traversa per tre zampe	140	1
L		
Vite per traverse	120	1
Zampe	90	3
Zampe	200	3
Zampe	250	3

Estrattore idraulico 10 TON a due e tre zampe con separatore
in cromo vanadio, cromati, viti e traverse bruniti
10 TON hydraulic puller set



Cod.	Pz./Pcs.		
AT1058	12	1	7500

Composizione:

	Aper. mm.	Pz.
Traversa per estrattore a due zampe	100	1
Traversa per estrattore a due zampe	140	1
Traversa per estrattore a tre zampe	100	1
Estrattore separatore	75	1
	L	
Serie di tre pz. Zampe	100	1
Serie di tre pz. Zampe	150	1
Serie di tre pz. Zampe	200	1
Prolunghe per traverse	105	2
Estrattore idraulico da 10 Ton		1
Prolunga per estrattore idraulico da mm.	50÷75	1

Estrattore a due zampe oscillanti con morsetto di tenuta
in cromo vanadio, cromato, viti bruniti
Two-arm puller used in confined areas

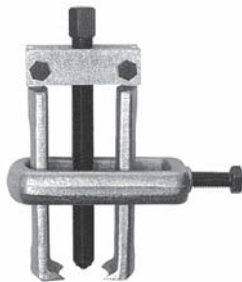

Cod.	Aper. mm	Prof. mm		
AT1036	70	130	1	2400

Estrattori per cuscinetti interni a sfera con gabbia
in cromo vanadio, cromati, viti e prolunghe bruniti
Puller removing blind housing bearing set



Cod.	Aper. mm	Prof. mm	Pz./Pcs.		
AT1038	90	205	9	1	830

Composizione:

	L.	Pz.
Traversa con vite	90	1
Prolunghe	120	2
	∅	
Testine oscillanti	5,5	2
Testine oscillanti	6	2
Testine oscillanti	8	2

Cavallotto di spinta
in cromo vanadio, cromato
Blind housing bearing remover



Cod.	Aper. mm	Prof. mm		
AT1040	90	40	1	440

Estrattori ad espansione per interni
acciaio al cromo vanadio, bruniti
Ball Bearing Puller for code AT1039



Cod.	mm		
AT1041	10	1	173
AT1042	12	1	180
AT1043	15	1	202
AT1044	17	1	217
AT1045	20	1	227
AT1046	25	1	244
AT1047	27	1	255
AT1048	30	1	325

Serie 9 estrattori ad espansione per interni
con cavallotto di spinta prof. 40 mm
acciaio al cromo vanadio, bruniti
Ball bearing eight internal puller set



Cod.	Aper. mm	Pz./Pcs.		
AT1039	90	9	1	2780

Composizione:

	∅	Pz.	∅	Pz.
	10	1	20	1
	12	1	25	1
	15	1	27	1
	17	1	30	1
	AT1040	1		

Espansori a quattro o sei settori per cuscinetti e piste interne
Ball bearing pullers



Cod.	Ø mm	Per Cod.		
AT4120	7-10	AT4107 - AT4130	1	17
AT4121	10-14	AT4107 - AT4130	1	17
AT4122	14-20	AT4107 - AT4130	1	19
AT4123	20-30	AT4107 - AT4130	1	23
AT4124	30-40	AT4107 - AT4130	1	25
AT4125	40-50	AT4108 - AT4131	1	270
AT4126	50-60	AT4108 - AT4131	1	590
AT4127	60-70	AT4108 - AT4131	1	710

Supporto a due bracci orientabili
2 swinging arms support for expanders



Cod.	Per. cod.		
AT4107	AT4120-AT4121-AT4122	1	500
AT4108	AT4125-AT4126-AT4127	1	1400

Percussore per espansori
Percussion pin for expanders



Cod.	Per. cod.		
AT4130	AT4120-AT4121-AT4122 AT4123-AT4124	1	1250
AT4131	AT4125-AT4126-AT4127	1	2500

Serie 5 estrattori ad espansione per cuscinetti piste interne
5 pcs. ball bearing puller set

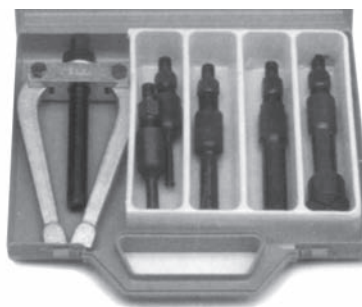

Cod.	Pz./Pcs.		
AT4110	6	1	2000

Composizione:

Cod.	Ø	Pz.
AT4120	7-10	1
AT4121	10-14	1
AT4122	14-20	1
AT4123	20-30	1
AT4124	30-40	1
AT4107		1

Serie 8 estrattori ad espansione per cuscinetti piste interne
8 pcs. ball bearing puller set



Cod.	Pz./Pcs.		
AT4111	10	1	7000

Composizione:

Cod.	Ø	Pz.
AT4120	7-10	1
AT4121	10-14	1
AT4122	14-20	1
AT4123	20-30	1
AT4124	30-40	1
AT4125	40-50	1
AT4126	50-60	1
AT4127	60-70	1
AT4107		1
AT4108		1

Estrattori completi di prolungha e separatore
Pullers with Extensions and separator



Cod.	Aper. mm	Prof. mm		
AT1049	60	240	1	1925
AT1050	75	240	1	1913
AT1051	115	240	1	4630
AT1052	150	430	1	11670

Separatori di ricambio per cod. AT1049÷AT1052 utilizzabili anche alla pressa idraulica
Spare separators for code AT1049 - AT1050 - AT1051 - AT1052

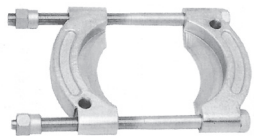

Cod.	mm		
AT1054	60	1	556
AT1055	75	1	620
AT1056	115	1	1675
AT1057	150	1	3880

Estrattori conici per viti e prigionieri spezzati
 acciaio al cromo molibdeno
Screw extractors removing broken bolts



Cod.	mm		
35001	M3-6	1	5
35002	M6-8	1	7
35003	M8-11	1	13
35004	M11-14	1	22
35005	M14-19	1	43
35006	M19-24	1	102

Serie 6 estrattori conici
 acciaio al cromo molibdeno
Screw extractor set - 6 pcs.



Cod.	Pz./Pcs.		
35000/6	6	1	220

Composizione:

Cod.	Ø	Pz.
35001	M3-6	1
35002	M6-8	1
35003	M8-11	1
35004	M11-14	1
35005	M14-19	1
35006	M19-24	1