

Estrattori universali a due zampe
in cromo vanadio, zincati, vite brunita
2 jaws standard pullers

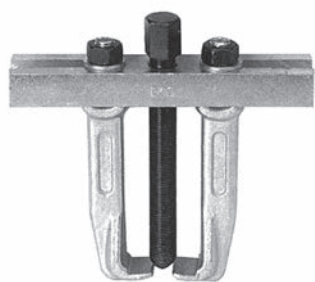

Cod.	Aper. mm	Prof. mm		
AT1010	60	75	1	350
AT1011	80	75	1	600
AT1007	100	75	1	650
AT1012	120	100	1	1200
AT1013	140	100	1	1400
AT1008	160	100	1	1500
AT1009	180	140	1	2600
AT1014	200	140	1	2700
AT1015	250	250	1	9000
AT1016	300	250	1	12500

Zampe di ricambio per cod. AT1010 ÷ AT1016
in cromo vanadio, zincate
Normal spare jaws for standard pullers



Cod.	Per codice		
AT1017	AT1010	1	70
AT1018	AT1007-AT1011	1	150
AT1019	AT1008-AT1012-AT1013	1	200
AT1020	AT1009-AT1014	1	300
AT1021	AT1015	1	1200
AT1022	AT1016	1	1500

Estrattori universali a tre zampe
in cromo vanadio, zincati, vite brunita
3 jaws standard pullers

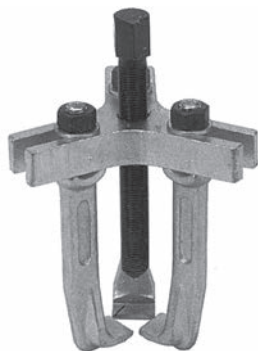

Cod.	Aper. mm	Prof. mm		
AT1023	90	75	1	850
AT1024	120	100	1	1550
AT1034	160	100	1	2000
AT1025	180	140	1	3900
AT1026	250	250	1	12000
AT1027	300	250	1	13000

Zampe di ricambio per cod. AT1023 ÷ AT1027
in cromo vanadio, zincate
Normal spare jaws for standard pullers



Cod.	Per codice		
AT1028	AT1023	1	100
AT1029	AT1024	1	210
AT1030	AT1025	1	450
AT1031	AT1026	1	1400
AT1032	AT1027	1	1500

Estrattori universali a due zampe scorrevoli
in cromo vanadio, zincati, vite brunita
2 jaws pullers for internal and external



Cod.	Aper. mm	Prof. mm		
2700/1	60	70	1	270
2700/2	80	100	1	800
2700/3	120	100	1	900
2700/4	160	150	1	2800
2700/5	200	150	1	3000
2700/6	250	200	1	6600

Estrattori autoserranti a due zampe
in cromo vanadio, zincati, vite brunita
adatto per diverse operazioni in autoriparazione.
*2 jaws self-tightening puller suitable
for different operations of self repairs*



Cod.	Aper. mm	Prof. mm		
AT4000	100	85	1	400
AT4001	140	120	1	900

Estrattori autoserranti a due zampe sottili

in cromo vanadio, zincati, vite brunita

2 jaws self locking pullers for exteriors and interiors with thin jaws



Cod.	Aper. mm	Prof. mm		
AT4010	55	40	1	150
AT4011	65	65	1	150
AT4012	80	80	1	300
AT4013	120	120	1	750
AT4014	160	160	1	1800
AT4015	225	200	1	3750
AT4016	300	300	1	8300
AT4017	425	425	1	10000

Estrattori autoserranti a tre zampe sottili

utilizzo in spazi ristretti

in cromo vanadio, zincati, vite brunita

3 jaws self locking pullers for exteriors and interiors with thin jaws to be used in narrow spaces



Cod.	Aper. mm	Prof. mm		
AT4020	55	40	1	240
AT4021	65	65	1	240
AT4022	80	80	1	450
AT4023	120	120	1	1050
AT4024	160	160	1	2500
AT4025	225	200	1	5200
AT4026	300	300	1	10000
AT4027	425	425	1	12400

Estrattori autoserranti reversibili a due zampe

in cromo vanadio, zincati, vite brunita

3 jaws self locking pullers for exteriors and interiors with a different shape of the jaws, it permits to operate in difficult situations



Cod.	Aper. mm	Prof. mm		
AT4030	150	80	1	800
AT4031	200	130	1	1900

Estrattori autoserranti reversibili a tre zampe

in cromo vanadio, zincati, vite brunita

3 jaws self locking pullers for exteriors and interiors with different shape of the jaws, it permits to operate in difficult situations



Cod.	Aper. mm	Prof. mm		
AT4040	150	80	1	1050
AT4041	200	130	1	2700

Estrattori autoserranti regolabili a due zampe

in cromo vanadio, zincati, vite brunita

2 jaws self locking pullers for exteriors and interiors jaws for strong stresses



Cod.	Aper. mm	Prof. mm		
AT4050	100	100	1	350
AT4051	150	150	1	900
AT4052	220	220	1	2100
AT4053	300	270	1	4500
AT4054	350	400	1	5200

Estrattori autoserranti regolabili a tre zampe

in cromo vanadio, zincati, vite brunita

3 jaws self locking pullers for exteriors and interiors jaws for strong stresses



Cod.	Aper. mm	Prof. mm		
AT4060	100	100	1	450
AT4061	150	150	1	1100
AT4062	220	220	1	3000
AT4063	300	270	1	6000
AT4064	350	400	1	7100

Estrattori universali a due zampe scorrevoli
in cromo vanadio, zincati, vite brunita
2 jaws pullers for exteriors and interiors sliding jaws along the transom. Clamping by the jaw bolts



Cod.	Aper. mm	Prof. mm	☞	☞
AT4070	80	98	1	1000
AT4071	130	98	1	1150
AT4072	160	150	1	3100
AT4073	200	150	1	3500
AT4074	250	200	1	6600
AT4075	350	200	1	7500
AT4076	520	200	1	13700

Zampe di ricambio per cod. AT4070÷AT4076
in cromo vanadio, zincate
Spare jaws for code AT4070÷AT4076



Cod.	Per cod.	Prof. mm	☞	☞
AT4080	AT4070÷AT4071	98	1	250
AT4081	AT4072÷AT4073	150	1	650
AT4082	AT4074÷AT4076	200	1	1600

Zampe prolungate di ricambio per cod. AT4070÷AT4076
in cromo vanadio, zincate
Spare jaws for code AT4070÷4076



Cod.	Per cod.	Prof. mm	☞	☞
AT4083	AT4070÷AT4071	200	1	500
AT4084	AT4072÷AT4073	300	1	1100
AT4085	AT4074÷AT4076	300	1	2200
AT4086	AT4074÷AT4076	400	1	2680
AT4087	AT4074÷AT4076	500	1	3200

Assortimento estrattori universali a due e tre zampe
in Cromo vanadio, cromati, vite brunita
Universal puller set



Cod.	Pz./Pcs.	☞	☞
AT1037	12	1	7700

Composizione:

	Aper. mm.	Pz.
Traversa per due zampe	140	1
Traversa per tre zampe	140	1
	L	
Vite per traverse	120	1
Zampe	90	3
Zampe	200	3
Zampe	250	3

Estrattore idraulico 10 TON a due e tre zampe con separatore
in cromo vanadio, cromati, viti e traverse brunitite
10 TON hydraulic puller set



Cod.	Pz./Pcs.	☞	☞
AT1058	12	1	7500

Composizione:

	Aper. mm.	Pz.
Traversa per estrattore a due zampe	100	1
Traversa per estrattore a due zampe	140	1
Traversa per estrattore a tre zampe	100	1
Estrattore separatore	75	1
	L	
Serie di tre pz. Zampe	100	1
Serie di tre pz. Zampe	150	1
Serie di tre pz. Zampe	200	1
Prolunghe per traverse	105	2
Estrattore idraulico da 10 Ton		1
Prolunga per estrattore idraulico da mm.	50÷75	1

Estrattore a due zampe oscillanti con morsetto di tenuta
 in cromo vanadio, cromato, viti brunite
Two-arm puller used in confined areas

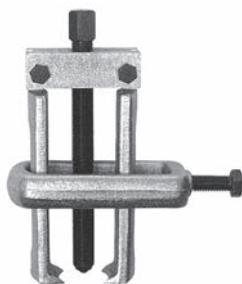

Cod.	Aper. mm	Prof. mm		
AT1036	70	130	1	2400

Estrattori per cuscinetti interni a sfera con gabbia
 in cromo vanadio, cromati, viti e prolunghe brunite
Puller removing blind housing bearing set



Cod.	Aper. mm	Prof. mm	Pz./Pcs.		
AT1038	90	205	9	1	830

Composizione:

	L.	Pz.
Traversa con vite	90	1
Prolunghe	120	2
	∅	
Testine oscillanti	5,5	2
Testine oscillanti	6	2
Testine oscillanti	8	2

Espansori a quattro o sei settori per cuscinetti e piste interne
Ball bearing pullers



Cod.	∅ mm	Per Cod.		
AT4120	7-10	AT4107 - AT4130	1	17
AT4121	10-14	AT4107 - AT4130	1	17
AT4122	14-20	AT4107 - AT4130	1	19
AT4123	20-30	AT4107 - AT4130	1	23
AT4124	30-40	AT4107 - AT4130	1	25
AT4125	40-50	AT4108 - AT4131	1	270
AT4126	50-60	AT4108 - AT4131	1	590
AT4127	60-70	AT4108 - AT4131	1	710

Supporto a due bracci orientabili
2 swinging arms support for expanders



Cod.	Per. cod.		
AT4107	AT4120-AT4121-AT4122 AT4123-AT4124	1	500
AT4108	AT4125-AT4126-AT4127	1	1400

Percussore per espansori
Percussion pin for expanders



Cod.	Per. cod.		
AT4130	AT4120-AT4121-AT4122 AT4123-AT4124	1	1250
AT4131	AT4125-AT4126-AT4127	1	2500

Serie 5 estrattori ad espansione per cuscinetti piste interne
5 pcs. ball bearing puller set

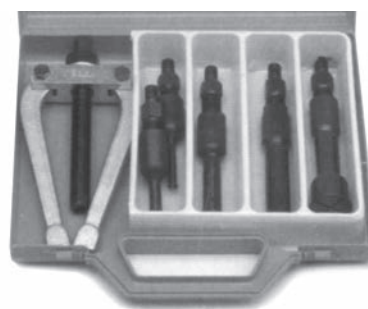

Cod.	Pz./Pcs.		
AT4110	6	1	2000

Composizione:

Cod.	∅	Pz.
AT4120	7-10	1
AT4121	10-14	1
AT4122	14-20	1
AT4123	20-30	1
AT4124	30-40	1
AT4107		1

Serie 8 estrattori ad espansione per cuscinetti piste interne
8 pcs. ball bearing puller set

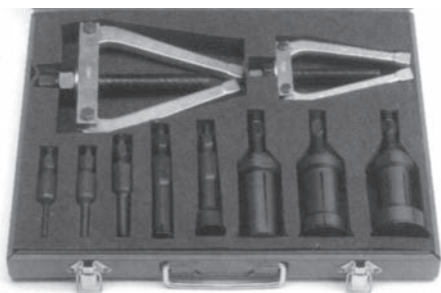

Cod.	Pz./Pcs.		
AT4111	10	1	7000

Composizione:

Cod.	Ø	Pz.
AT4120	7-10	1
AT4121	10-14	1
AT4122	14-20	1
AT4123	20-30	1
AT4124	30-40	1
AT4125	40-50	1
AT4126	50-60	1
AT4127	60-70	1
AT4107		1
AT4108		1

Estrattori completi di prolungha e separatore
Pullers with Extentions and separator



Cod.	Aper. mm	Prof. mm		
AT1049	60	240	1	1925
AT1050	75	240	1	1913
AT1051	115	240	1	4630
AT1052	150	430	1	11670

Separatori di ricambio per cod. AT1049÷AT1052 utilizzabili anche alla pressa idraulica
Spare separators for code AT1049 - AT1050 - AT1051 - AT1052

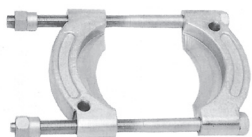

Cod.	mm		
AT1054	60	1	556
AT1055	75	1	620
AT1056	115	1	1675
AT1057	150	1	3880

Estrattori conici per viti e prigionieri spezzati
 acciaio al cromo molibdeno
Screw extractors removing broken bolts



Cod.	mm		
35001	M3-6	1	5
35002	M6-8	1	7
35003	M8-11	1	13
35004	M11-14	1	22
35005	M14-19	1	43
35006	M19-24	1	102

Serie 6 estrattori conici
 acciaio al cromo molibdeno
Screw extractor set - 6 pcs.



Cod.	Pz./Pcs.		
35000/6	6	1	220

Composizione:

Cod.	Ø	Pz.
35001	M3-6	1
35002	M6-8	1
35003	M8-11	1
35004	M11-14	1
35005	M14-19	1
35006	M19-24	1

Giraschi tipo "GOODELL"
 con mandrino a quattro settori - acciaio al carbonio, zincati
Tap wrenches T handle



Cod.	Misura			
AT3053	2÷4	150	1	110
AT3054	2÷4	200	1	150
AT3055	5÷7	150	1	170
AT3056	5÷7	200	1	195
AT3057	8÷9	100	1	170
AT3058	8÷9	150	1	230
AT3059	8÷9	200	1	260
AT3060	10÷12	100	1	230
AT3061	10÷12	150	1	280
AT3062	10÷12	200	1	350

Giramaschi tipo "GOODELL"

con mandrino a quattro settori - acciaio al carbonio, zincati
Tap wrenches T handle



Cod.	Misura			
AT3050	0÷2	60	1	40
AT3051	2÷4	80	1	80
AT3052	5÷7	90	1	125

Giramaschi tipo estensibile DIN 1814

acciaio forgiato, ganasce carbonitruurate, manici zincati, corpo verniciato
Tap wrenches

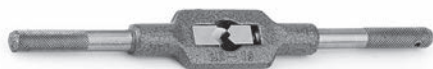

Cod.	Misura			
AT3067	1÷8	130	1	56
AT3068	2÷10	180	1	100
AT3069	4÷14	280	1	245
AT3070	5÷21	380	1	580
AT3071	9÷27	490	1	910
AT3072	13÷33	630	1	1330
AT3073	19÷39	820	1	1790
AT3074	27÷64	820	1	1790

Girafiliere doppio

completo di asta di manovra - acciaio al carbonio, zincato
Double die handle

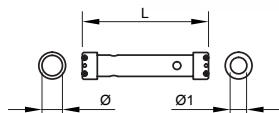

Cod.	Ø			
AT3063	20,6x25,4	160	1	400
AT3064	25x38,1	190	1	500
AT3065	18x45	195	1	500
AT3066	38x50,8	215	1	1000

Girafiliere in acciaio ISO 2568 UNI

acciaio forgiato, manici zincati, corpo verniciato
Die handle

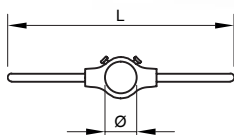

Cod.	Ø est.	Filiera			
AT3075	16,2	M 1÷5	200	1	95
AT3076	20,6	M 2÷8	205	1	86
AT3077	25,4	M 2÷10	225	1	119
AT3078	31,7	M 5÷12	275	1	202
AT3079	38,1	M 6÷18	335	1	293
AT3080	50,8	M 16÷24	500	1	953
AT3081	63,5	M 24÷33	625	1	1266
AT3082	76,2	M 38÷45	705	1	1825

Girafiliere in acciaio ISO 2568 DIN

acciaio forgiato, manici zincati, corpo verniciato
Die handle

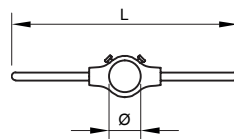

Cod.	Ø x S	Filiera			
AT3083	16x5	M 1÷2,6	200	1	95
AT3084	20x5	MF 3÷4	205	1	90
AT3085	20x7	M 4,5÷6	205	1	90
AT3086	25x9	M 7÷9	225	1	120
AT3087	30x11	M 10÷11	280	1	190
AT3088	38x10	MF 12÷14	335	1	300
AT3089	38x14	M 12÷14	335	1	295
AT3090	45x14	MF 16÷20	405	1	545
AT3091	45x18	M 16÷20	405	1	525
AT3092	55x16	MF 22÷24	500	1	915
AT3093	55x22	M 22÷24	500	1	875
AT3094	65x18	MF 26÷35	625	1	1270
AT3095	65x25	M 27÷36	625	1	1200
AT3096	75x20	MF 38÷42	705	1	1875
AT3097	75x30	M 39÷42	705	1	1815
AT3098	90x36	M 45÷52	900	1	2000

Estrattori per baderne flessibile con punta fissa a spillo

corpo zincato, punta protetta con antiossidante
Flexible extractors for braids with fixed tips

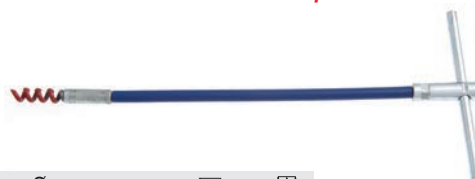

Cod.	Ø			
22401	4	200	1	40
22402	6	200	1	40
22403	8	230	250	80
22404	10	300	350	120

Estrattori per baderne flessibile con punta intercambiabile a spillo

corpo zincato
Flexible extractors for braids with interchangeable tips



Cod.	Ø			
22405	4	170	1	30
22406	6	170	1	30
22407	8	230	1	60
22408	10	300	1	100

Ricambi per baderne a spillo cod. 22405-22408

corpo zincato, punta protetta con antiossidante
Spare tips



Cod.	Ø			
22409	4	40	1	10
22410	6	40	1	10
22411	8	50	1	20
22412	10	50	1	30